

RULES & REGULATIONS AND DIRECTORY

Camp Creek Lake
and Camp Creek Water Co. Property

PLEASE READ

11069 Riley Green Rd
Franklin, TX 77856
(979) 828-2907 Phone
E-mail: ccwc@windstream.net
Website: <http://www.campcreeklake.us/>

AUGUST 2022

Officers and Directors are elected at the CCWC Annual Shareholders Meeting

Fees

Annual permit fee is set by the Board of Directors.

Notice to New Lot Owners

Annual Permits are full price regardless of the time of the year they are purchased except as noted below.

The cost of the FIRST Annual Permit will be prorated according to the following schedule, with the date of purchase of your Lot being the determining date.

Additionally, a lot owner who transfers his lot will be entitled to a refund based on the transfer date of the lot.

If purchased during the period of:

February 1 to April 30 - 100%
May 1 to July 31 - 75%
August 1 to October 31 – 50%
November 1 to January 31 – 25%

If transferred during the period of:

February 1 to April 30 – 100%
May 1 to July 31 – 75%
August 1 to October 31 – 50%
November 1 to January 31 – 25%

Contact Information

Office Manager (979) 828-2907
Lake Patrolman (979) 906-8064
E-mail address: ccwc@windstream.net
Camp Creek Website address: www.CampCreekLake.us

Camp Creek Water Company Office/Mailing Address:
11069 Riley Green Road
Franklin, Texas 77856

Annual Stockholders Meeting

Fourth Saturday in April at the Franklin ISD Auditorium or as designated

IMPORTANT TELEPHONE NUMBERS:

Robertson County's Sheriff's Department (979) 828-3299
Precinct 3 Constable (979) 828-2122

Robertson County Judge (979) 828-3542
Precinct 3 Commissioner (979) 828-4413

Navasota Valley Electric Cooperative (979) 828-3232
Twin Creek Water Supply Co. (979) 828-5385
Windstream Communications (800) 843-9214

Table of Contents

Page NO.

1. Annual Camp Creek Water Company (CCWC) Permit (Compulsory)	5
2. Non- Lot Owners Annual Use Permit	5
3. Fiscal Year	5
4. Nuisance and Guest Behavior (see deed restrictions)	5
5. Solicitations for Sales	5
6. Speed Limit	6
7. Improvements and Alterations to CCWC Property	6
8. Pumping Lake Water	7
9. Aquatic Vegetation Treatment	7
10. Felony and Theft	7
11. Dogs and other Pets (General)	7
12. Firearms	7
13. Policing	8
14. Violations	8
15. Reporting Violations	8
16. Rules and Regulations	8
17. Patrolman	8
18. Complaints	8
19. Vegetation	8
20. Paint Ball Guns	9
21. Electrical Safety for Boat Houses	9
22. Driving and Accident Reports	9
23. ORV (Off Road Vehicle) Registration and Operation	9,10
24. Fishing	10,11
25. Hunting, Shooting, and Trapping	11,12
26. Motorized Watercraft Registrations (Boat's and Jet-Ski's)	12-15
27. Kite Tube Watercraft	15
28. Guest Provisions	15-17
29. Dam and Recreation Area - Eligible Users	17-18
30. Septic Systems	18
31. Entities as Lot Owners	18
32. Rental Property	18

RULES AND REGULATIONS FOR CCWC PROPERTY AND FACILITIES

1. Annual CCWC Permit (Compulsory)

- 1.1 All Lot Owners are required to purchase an Annual Permit for each lot owned. Annual Permits shall be good from February 1st to January 31st of the following year. For purposes of Annual Permit Dues only, multiple lot(s) owners are able to assign one adult child or parent to their additional lot(s).
- 1.2 Annual Permits are not transferable.
- 1.3 Permit covers Lot Owner and spouse. Children under 21 years of age are considered guest with no written permit required.
- 1.4 Other relatives, including married children and children twenty-one (21) years of age and older assume the same status as any other guest, and shall be subject to the Rules and Regulations (rules) applying to guests.
- 1.5 An Annual Permit allows unlimited guests per day to use CCWC property **as long as the Annual Permit holder is with his/her guests.** (No daily guest permit required)
- 1.6 Only an **Annual Permit Holder** may purchase Daily Guest Permits. **Limit two books per year. (Year beginning February 1st of each year).**

2 Non-Lot Owners Annual Permit

- 2.1 Only immediate family members who have the use of the Lot Owner's lot may purchase a Non-Lot Owner's Annual Permit.
- 2.2 The definition of immediate family is a Lot Owner's parents, siblings, adult children twenty-one (21) years of age, their spouses and grandchildren.
- 2.3 Non-Lot Owners are subject to all Rules and Regulations.
- 2.4 Non-lot owners shall not use the recreation area for camping.

3 Fiscal Year

- 3.1 The fiscal year is January 1st, through December 31st.

4 Nuisance and Guest Behavior

- 4.1 Any Annual Permit holder creating or maintaining a nuisance will be guilty of violating these rules.
- 4.2 Annual Permit holder will be responsible for the behavior of his/her guests and shall be FINANCIALLY RESPONSIBLE for any DAMAGES his/her guests may cause to CCWC.
- 4.3 Disciplinary action will be taken against violators of these rules by Board of Directors.

5 Solicitations for Sales

- 5.1 In accordance with original deed Restriction Number Four (4) placed in deeds to lots at Camp Creek, solicitation for Garage, Auctions, Estate Sales or similar type sales are prohibited.

6 Speed Limit

- 6.1 A speed limit of 30 MPH or as posted must be observed.
- 6.2 Speeds in excess of 30 MPH or as posted will be in violation of Rules and Regulations and will be handled as such.
- 6.3 An actual clocking of a violation will not be necessary.
- 6.4 Visual observance of a speed in excess of 30 MPH or reckless driving can easily be determined.
- 6.5 Operators of a licensed vehicle must have a current and valid driver's license when driving on CCWC property.
- 6.6 **Slow down** for everyone's safety.

7 Improvements and Alterations on CCWC Property

- 7.1 Lot Owners desiring to make **ANY** improvements on or alterations of CCWC property for any purpose, must first submit a Building Permit application for authorization to use CCWC property, in duplicate, with attached lot survey, accurate site plan and photos of the site, to the Office Manager
- 7.2 Allow at least 30 days for inspection and review, **PRIOR** to planned start of construction.
- 7.3 Improvements and alterations that are started prior to the issuance of the permit approval will be delayed until authorization is granted.
- 7.4 Applications may be secured from the Office Manager or online at the Camp Creek web site.
- 7.5 Permits will be considered only for those Lot Owners that have purchased a current Annual Permit.
- 7.6 The Lot Owner, by submitting this application, further agrees that they shall continue to purchase an Annual Permit each fiscal year so long as he/she owns the lot.
- 7.7 When a lot is transferred, the previous owner passes this obligation to the new owner.
- 7.8 The Lot Owner also agrees to remove or pay the cost of removal of any granted improvements when ordered to do so by the CCWC Board of Directors.
- 7.9 The Lot Owner also agrees to keep the facility placed on CCWC property in a state of good repair so that it shall in no way become a hazard to any Lot Owner or guests.
- 7.10 The Board of Directors for CCWC reserves the right to revoke these permits at any time.
- 7.11 Failure to purchase an Annual Permit by February 1st of each year shall automatically revoke the granted use authorization, and the terms as stated above shall apply.
- 7.12 Lot numbers, a minimum of 3" and readable from the lake, are required on **all** boat houses/piers.
- 7.13 Improvements including septic systems, buildings, fences, propane tanks or private boat ramps are not allowed on CCWC property.

8. Pumping Lake Water

8.1 Lot Owners desiring to pump water from Camp Creek Lake (CCL) for use on their lot must first secure a pumping permit from the Secretary-Treasurer.

9. Aquatic Vegetation treatment

9.1 Lot Owners desiring to chemically treat the vegetation in front of their lots may do so with commercial chemical specifically labeled for that purpose so long as the chemical analysis of the product does **NOT** contain any SODIUM ARSENATE.

10. Felony and Theft

10.1 Any person committing a felony or theft of any grade on CCWC or any other Lot Owner's property, may (at the discretion of the Board of Directors) be barred from going on CCWC property.

11. Dogs and other Pets

11.1 Lot Owners will be held responsible for their (and their guest's) pets.

11.2 Pets of **any kind** must be under the control of Lot Owners and their guests at all times and not present a nuisance to others.

11.3 Dogs shall not be allowed to roam on CCWC property.

11.4 Dogs are not allowed at the recreation area without being controlled by a leash.

11.5 Owners must pick up after their dogs at the recreation area.

11.6 Dog owner must have proof of current valid rabies vaccination, and the dog should have a tag with owner's phone number and/or address on tag.

11.7 Animals and pets are not allowed inside the Ray Brodin building when food is present.

11.8 No pets or wildlife of any kind may be introduced onto CCWC property/lake without prior approval from the CCWC Board of Directors.

12. Firearms

12.1 No person shall discharge a bow, shotgun, pistol or rifle of any caliber down, across, or from CCWC's:

- a. Roads;
- b. Pipe lines;
- c. Power line right of ways;
- d. Lots owned by CCWC; or
- e. Fenced well sites;

12.2 In accordance with original deed Restriction Number Five (5) placed in deeds to lots at Camp Creek, no person shall use or discharge any firearm using shot shell larger than a standard No. 4 shot on CCL.

12.3 This regulation also applies to all lots at Camp Creek as evidenced by Restriction No. 5 contained in all original deeds.

13. Policing

- 13.1 The CCWC is not responsible for the policing of your lot.
- 13.2 Policing your lot is the responsibility of the Sheriff's Department of Robertson County, Texas.
- 13.3 Our Lake Patrolman will patrol CCWC property and will assist you and the Sheriff's Department in every way possible.

14. Violations

- 14.1 Any person violating any of these Rules and Regulations shall be subject to penalties by the Board of Directors which may include:
 - a. Fines, suspension, or cancellation of Annual Permit privileges.
 - b. Being barred from going on CCL or any property of CCWC.
 - c. Filing of trespassing charges.
 - d. Penalties against guests will be levied against responsible Lot Owner.

15. Reporting Violations

- 15.1 The name of any person who reports a violation of these rules will not be revealed if the person furnishing information so requests.

16. Rules and Regulations

- 16.1 The Rules and Regulations may be changed or amended at any time at the discretion of the Board of Directors.

17. Patrolman

- 17.1 The Lake Patrolman is under the direction of the Board of Directors and is charged with reporting violations of these rules.
- 17.2 All permit holders and guests shall cooperate with the Patrolman at all times.

18. Complaints

- 18.1 Any complaints concerning the Lake Patrolman, Lot Owners, Annual Permit holders or with the operation of the CCWC should be submitted in writing to the Office Manager for referral to the Executive Committee.
- 18.2 The Office Manager is charged with the daily operation of CCWC under the direction of the Executive Committee.

19. Vegetation

- 19.1 No water vegetation of any kind may be introduced into CCL except as done by the Lake Fishing/Vegetation Committee.
- 19.2 Care should be taken with plant life on land so that drainage will not accidentally introduce plants into the lake.
- 19.3 Violators of this rule may be charged with the expense of removal of said plants.

20. Paint Ball Guns

20.1 No discharge of paint ball guns allowed on CCWC property for any reason.

21. Electrical Safety for Boat Houses

21.1 NEC (National Electric Code) is to be followed for new construction and alterations.

22. Driving and Accident Reports

22.1 Operators of a licensed vehicle must have a current and valid driver's license when driving on CCWC property.

22.2 All Annual Permit Holders and Lot Owners/guests must report any accidents on CCWC property to the Office Manager and Lake Patrolman as soon as possible after the occurrence of the accident.

23. ORV (Off Road Vehicle) Registration and Operation

23.1 Only Annual Permit holders may register ORVs for CCWC property use.

23.2 A Daily Guest Permit does not allow that person to place an ORV on CCWC property.

23.3 Proof of ownership of an ORV is required. A title or a notarized bill of sale is required for proof of ownership.

23.4 **Prior to** placing an ORV on CCWC property, it must be registered with the Office Manager.

23.5 The identification sticker furnished to the owner at the time of registration must be attached to an ORV.

23.6 ORVs must have lot numbers a minimum of 3" and clearly legible, affixed to both sides of ORV before it is allowed to operate on CCWC property.

23.7 Working lights are required on all ORVs when riding at night.

23.8 No Annual Permit holder shall allow a guest or anyone else without an Annual Permit to place an ORV on CCWC property.

23.9 **No other** ORVs are allowed on CCWC property.

Trial ORV

23.10 Prior to testing, Annual Permit holders wishing to try out a new ORV must contact the Lake Patrolman to arrange a meeting to allow him to check the ORV. The Lake Patrolman's decision as to granting a trial will be final.

Maximum Number of ORVs

23.11 In an effort to control the safety on CCWC property, each Lot Owner is restricted to a maximum of four (4) ORVs registered to his/her lot.

23.12 This total may be comprised of those owned by the permitted Lot Owner, and/or by the permitted non-lot owner.

23.13 No replacement registration stickers will be issued until such time as the number of ORVs conforms to this section of the Rules and Regulations.

- 23.14 All ORVs operated on CCWC property must have proper exhaust housing and mufflers in place so that ORVs will operate with only a normal noise level and within the Motorcycle Industry Council's recommended sound pressure level (db).

ORV Safety

- 23.15 Operators of ORV's **less than 13 years of age must be accompanied by an adult at all times** while operating ORVs on CCWC property.
- 23.16 Operators of ORVs are encouraged to wear approved personal protective equipment and illuminate headlights at all times while riding.
- 23.17 Observed unsafe operation of an ORV on CCWC property will be grounds for suspension of the registration permit for offending ORV.
- 23.18 Any person operating, or riding on an ORV on CCWC property does so at his/her own risk. CCWC assumes no responsibility for accidents and/or injuries resulting from the operation of an ORV on CCWC property.**

24. Fishing

- 24.1 No person shall be allowed to fish on the premises of the CCWC who has not first obtained one of the following covering the period of time in which the fishing occurs:
- a. An Annual Permit (allows a total of four (4) guests per day, per lot to use CCWC property as long as Annual Permit holder is with his/her guests.)
 - b. A Daily Guest Permit.
- 24.2 No person shall be allowed to fish upon the premises of CCWC who is under suspension for violation of any Rules or who has not paid fines assessed against him/ her.
- 24.3 No person is allowed to introduce fish (other than bait used for fishing) into CCL. Fish may be introduced by the Fishing/Vegetation Committee.
- 24.4 No watercraft shall tie off to any channel marker.

Use of Gill or Hoop Nets

- 24.5 The use of gill, hoop, or trammel nets is prohibited except for Fishing and Vegetation Committee activities.

Use of Trot, Throw, and/or Jug lines

- 24.6 No trot line shall be permitted in CCL on which are attached more than 50 hooks.
- 24.7 Lines shall not be placed in or across any channel or regular boat lane traffic. Jug lines must be anchored. No free-floating jug lines are allowed.
- 24.8 **Owner's name, lot number and date** must be placed or attached to the end of the trot, throw, or jug lines.

- 24.9 Trot and jug lines shall not be left in the lake for over 15 days without being used, and may be removed by the Lake Patrolman if not used within the 15-day limit.
- 24.10 Fishing is permitted in the spillway discharge behind the dam.
- 24.11 Fishing from (or climbing in or on) the service spillway structure is prohibited except when being inspected or repaired by Dam/Recreation Committee.

Fishing Barges

- 24.12 Fishing barges are provided by CCWC for the use of all Annual Permit holders and their guests.
- 24.13 Watercraft and other equipment shall not be placed on or beside fishing barges in such a manner as to monopolize their use and to discourage other permit holders from coming aboard for the purpose of fishing.

Fishing: Catch and Release

- 24.14 To encourage larger bass in CCL, all permit holders and guests are encouraged to catch and release all bass over four (4) pounds.

25. Hunting, Shooting, and Trapping

- 25.1 Where allowed by Camp Creek Board of Directors, **ALL** hunting on CCL is done using current Texas Parks and Wildlife regulations in effect at time of hunt.
- 25.2 No taking of deer by **any** means from CCWC property except for activities of the Wildlife Committee
- 25.3 Any permit holder found in violation of this regulation will have his/her Annual Permit cancelled and shall be fined \$1000.00 by the Board of Directors. No subsequent Annual Permit will be issued until the fine is paid.

Duck Blinds

- 25.4 No person shall build or place a stationary or permanently-anchored duck blind on CCL without first receiving a building permit to do so.
- 25.5 All such blinds shall become the property of the CCWC and shall be usable by any hunter on a first come, first served basis.
- 25.6 A person may use a mobile blind which he/she takes to the hunting site and returns to his/her lot at the end of the day's hunt.

Nutria Control

- 25.7 Lot Owners are allowed to take Nutria as they can from the confines of their lot shoreline immediately adjacent to their lot.
- 25.8 Lot Owners may not take Nutria from a boat, as such action might endanger the lot owners on CCL.

25.9 Any heavy concentrations of Nutria should be reported to the Lake Patrolman.

Trapping

25.10 There shall be no trapping on CCWC property with the following exceptions:

- a. The necessary nuisance control of any animal (using Texas Parks and Wildlife regulations) shall be handled under the supervision of the Board of Directors.
- b. Using Texas Parks and Wildlife regulations, feral hogs are allowed to be trapped on Lot Owner's premises.

26. CCWC Motorized Watercraft Registrations (Boats and Jet-Skis)

26.1 Only Annual Permit holders may register motorized watercraft for CCL use.

26.2 A Daily Guest Permit does not allow a person to place a motorized watercraft on CCL.

26.3 Proof of ownership is required. A title issued by Texas Parks and Wildlife or a notarized bill of sale is required for proof of ownership.

26.4 **Prior** to placing a motorized watercraft on CCL, proof of ownership must be presented to the Office Manager of CCWC, who will then register the boat and issue a registration sticker.

26.5 The registration sticker must be affixed by the Patrolman and must be attached to the transom of boat, and be located above the water line. Registration sticker for a Jet-Ski should be located in a visible location. Lot owner will be responsible for upkeep.

26.6 Motorized watercraft without a proper registration sticker and lot numbers at least three (3) inches permanently affixed to both sides above the water line will not be allowed to operate on CCL. **A violation of the above rules will result in a \$100. fine.**

Legal Motorized Watercraft

26.7 Each motorized watercraft placed on CCL must be owned by an Annual Permit holder.

26.8 No Annual Permit holder shall allow a guest or anyone else without an Annual Permit to place a boat on CCL.

26.9 **No** other motorized watercraft are allowed.

26.10 As of January 1st, 2018, no new registrations will be issued to motorized watercraft greater than 26' in length. Additionally, no multi-engine watercraft, nor engines that exceed 300 horse power will be registered.

Trial Motorized Watercraft

26.11 Prior to testing, Annual Permit holders wishing to try out a new motorized watercraft must contact the Lake Patrolman to arrange a meeting to allow him to check the watercraft. The Lake Patrolman's decision as to granting a trial will be final.

Maximum Number of Motorized Watercraft

- 26.12 In the interest of safety and to control the congestion on the lake, each Lot Owner is restricted to a maximum of two motorized boats, and two Jet-Skis that may be registered to his/her lot.
- 26.13 This total may be comprised of motorized watercraft owned by the permitted Lot Owner and/or permitted non-lot owners.
- 26.14 No replacement registration stickers will be issued until such time, as the number of motorized watercrafts conform to this section of the Rules and Regulations.
- 26.15 An unlimited amount of non-motorized watercraft are allowed. Each one should have lot numbers at least three (3) inches high affixed to both sides.

Motorized Watercraft Safety

- 26.16 All motorized watercraft, in meeting another watercraft, shall slow to a moderate rate of speed and allow at least 50 feet of clearance between motorized watercraft wherever possible.
- 26.17 When meeting or passing another motorized watercraft, extreme care shall be exercised so as not to endanger the occupants of the other motorized watercraft.
- 26.18 It is recommended that an operator of a motorized watercraft used on CCL be familiar with, and follow the safety requirements under the Texas Water Safety Act. (Refer to <http://tpwd.texas.gov>)
- 26.19 **(PWC's)** A PWC cut off or kill switch must be attached to the operator or the operator's clothing.
- 26.20 **(PWC's)** The operation of a PWC is prohibited ½ hour before sunset, and a ½ hour before sunrise.
- 26.21 **(PWC's)** A **Mandatory** \$250 fine will be assessed if anyone is observed operating or being a passenger on a PWC on CCL without wearing a Coast Guard approved life jacket.

No one under the age of 13 years shall operate a PWC.

Any individual or passenger in a motorized watercraft operating on CCL does so at his/her own risk. CCWC assumes no responsibility for accidents and/or injuries resulting from the operation of a motorized watercraft on CCL.

Passenger Capacity

- 26.22 Each watercraft operator on CCL should be familiar with the number of passengers and weight/capacity of his/her boat.

Illegal Watercraft

- 26.23 No watercraft shall be permitted on CCL that are equipped with a toilet, or living accommodations.

26.24 No airboats allowed without prior consent from the BOD or unless used for Fishing/Vegetation Committee activities.

Lights

26.25 All watercraft operating at night on CCL are required to show a light visible for at least 500 feet in **ALL** directions.

Motor Exhausts

26.26 All motorized watercraft operated on CCL must have proper exhausts and exhaust plates. Housings must be in place in order to operate with only a normal amount of noise.

Skiing and Tubing Area

26.27 No skiing, surfboarding, aquaplaning, or tubing of any sort is permitted except in the designated ski area as shown on the map in this pamphlet, and **is at your own risk**. All tubers and skiers must wear a Coast Guard approved life jacket. A **Mandatory** \$250 fine will be assessed if anyone is observed water skiing, or riding a tube without wearing a Coast Guard approved life jacket.

26.28 There are submerged underwater hazards, even in designated areas. Special care should be taken during periods when the lake level is below the service spillway elevation.

Ski Pattern

26.29 Skiers and motorized watercraft operators shall follow in a counter-clockwise pattern, including takeoff, with slower boats using the inside of the pattern.

26.30 Above rule applies to all motorized watercraft operating in an area where skiing is taking place, whether they are **pulling skiers or not**.

Ski Safety

26.31 No motorized watercraft shall operate closer than 150 feet from the shore at the Recreation Area point except when docking or taking off with a skier.

26.32 Motorized watercraft and skiers shall not pass between safety markers in front of the swimming area.

26.33 Under no circumstance shall any motorized watercraft operator cut in between a skier and the motorized watercraft pulling the skier.

26.34 At no time shall a motorized watercraft follow closely and directly behind the skier being pulled by another motorized watercraft.

26.35 Under no circumstances will a skier take off one ski and leave it in the ski pattern area.

26.36 If a skier desires to remove one ski, he/she must do so as he/she passes near the point of takeoff. The dropped ski must be retrieved and removed from the water **immediately** by someone in the skier's party.

26.37 A motorized watercraft operator may not tow another person behind a watercraft between ½ hour after sunset and ½ hour before sunrise.

26.38 Any individual skiing on CCL does so at his/her own risk.

Take Off Area

26.39 Skiers shall take off from the western end of the recreation area and shall not use the swimming pier or area for this purpose.

Motorized Watercraft Parking

26.40 Motorized watercraft, when not pulling skiers, shall be parked between swimming pier and dam at piers, leaving point clear for skiers.

Skier Pickup and Rules

26.41 When a skier falls, the motorized watercraft operator shall check for following boats, turn left out of the ski pattern and use caution in re-entering the pattern to pick up skier.

26.42 Any motorized watercraft, before entering the TAKE OFF AREA, shall retrieve the ski rope.

Motorized Watercraft Wake

26.43 Motorized watercraft operating outside of the ski area and designated boat lanes will be operated in such a manner and at such speed so as to avoid creating wakes that might damage other watercraft that are docked.

26.44 Particular care must be observed by water craft during those times when the lake is at flood stage. Even small wakes can cause extensive damage to boats and equipment that are housed within boathouses during these flood times.

27. Kite Tube or Water Jet Pack Watercraft

27.1 **NO** kite tube, water jet pack or similar devices allowed on CCL.

28. Guest Provisions

28.1 A Lot Owner holding an Annual Permit may purchase Daily Guest Permits for guests to use on CCWC property when not accompanied by the lot owner.

28.2 A Daily Guest Permit does not allow guests to place a watercraft or ORV on CCWC property.

28.3 Unlimited number of guests are allowed in front of the owner's/permit holder's lot for **SWIMMING ONLY**, with permit holder present.

Availability of Daily Guest Permits

- 28.4 Daily Guest Permits may be obtained by an Annual Permit holder/Lot Owner by purchasing a book of 10 permits (Maximum of two books per year) from the Office Manager's office for \$40.00 during business hours. Please call the office at 979-828-2907 to ensure the Office Manager is in. The office is located at 11069 Riley Green Rd. Franklin, TX. 77586.
- 28.5 It takes one completely-filled-out Daily Guest Permit per person, per day for people twelve (12) years old and older.
- 28.6 All Daily Guest Permits shall be valid until midnight of the date on the permit.

Guest Requirements

- 28.7 All Lot Owners holding an Annual Permit are allowed to have guests who are permitted to fish, hunt, boat ride, ride ORV's, swim, water ski, or tube ride, subject to the following terms and conditions:
- 28.8 **Each** guest must, when upon the property of the CCWC for any purpose requiring a permit, **have available for inspection by the Lake Patrolman, or any officer of CCWC**, a Daily Guest Permit signed and properly filled out by the Annual Permit holder/Lot Owner sponsor of the guest, showing the date upon which, the permit is valid for the use of the lake.
- 28.9 Guests shall be permitted to operate a properly-registered water craft or ORV on CCWC property without being accompanied by an Annual Permit holder as long as said guest has in his/her possession a properly-issued Daily Guest Permit covering the period of operation.
- 28.10 If hunting, fishing, skiing, or surfboarding equipment is in the boat, it shall be presumed that every person in the boat is hunting; fishing; skiing or surfboarding. Therefore, everyone in the boat must have a proper permit or be in violation of these rules.
- 28.11 All guests who swim at any place in CCL other than in front of the lot owned by the Annual Permit holder/Lot Owner must either have a Daily Guest Permit or be covered under the four-guest provision of the Annual Permit.
- 28.12 All children under twelve (12) years of age are hereby exempted from paying for Daily Guest Permits.

Controls on Daily Guest Permits

- 28.13 It is the responsibility of the Annual Permit holder/Lot Owner to control who gets a Daily Guest Permit.
- 28.14 When a Daily Guest Permit is used, it must be completely-filled out and signed by the Annual Permit holder/Lot Owner.
- 28.15 It must be understood that when a Daily Guest Permit is issued to a guest, the Annual Permit holder/Lot Owner is responsible for the actions of the guest and his/her pets while using the lot and/or CCWC property.

House Guests

28.16 It must be understood that a Lot Owner/Annual Permit holder shall be held directly responsible for any actions of his/her guests that may be in violation of any CCWC Rules, Regulations and deed restrictions.

Responsibility for guests

28.17 It is the responsibility of the Annual Permit holder/Lot Owner to see that all his/her guests are properly permitted before entering on CCWC premises for any purpose for which a Daily Guest Permit is required.

29. Dam and Recreation Area - Eligible Users

29.1 The recreation area located at the east end of the lake near the dam is provided for the exclusive use of Annual Permit holders and Daily Guest Permit holders.

29.2 Any unauthorized person using this area may be prosecuted for trespassing.

Swimming Restrictions

29.3 All swimming in this area will be confined to the roped-off swimming area.

29.4 All swimmers shall KEEP OFF any floating buoys placed in the area to protect swimmers from skiers.

29.5 No swimming is allowed in the area used by skiers to take off and land or in the open area used for skiing.

No Camping

29.6 The recreation area shall not be used for overnight camping.

Alcoholic Beverages

29.7 The open display of alcoholic beverages is prohibited at the recreation area or in water craft anchored or tied up at this area.

Parking of Cars and Trailers at Warren McKenzie Pavilion

29.8 The Pavilion may be reserved by Annual Permit holders only by contacting the Office Manager.

29.9 All cars, trucks, and boat trailers shall be parked in an area that will not interfere with the use of the boat launching facilities by other persons.

29.10 There is a gravel parking area at the north end of the dam for extra parking.

Vehicles on Dam

29.12 Under no circumstances shall any motorized vehicles be driven or ridden on the top of or the sides of the dam. Such actions are both dangerous and detrimental to keeping the dam in good condition.

29.13 The only exception to this access is equipment used to maintain the dam as required by the Dam/Rec Committee.

Curfew

29.14 All activities at recreation area will cease at 10:00 P.M. nightly.

Trash Disposal

29.15 The users are required to take their trash from the area for proper disposal elsewhere.

30. Septic Systems

30.1 All on-site sewage facilities shall meet the requirements of the Texas Commission on Environmental Quality (TCEQ).

30.2 A permit from the State of Texas is required for the installation of a new septic system or any repair or modification of an existing system.

30.3 Septic systems shall be wholly contained on the Lot Owner's lot.

30.4 Placement of any part of the septic system on CCWC property is prohibited.

31. Entities as Lot Owners

31.1 If a Lot is owned by an "entity" as that term is defined in Section 1.002 (21) of the Texas Business Organizations Code (including but not limited to a corporation, limited liability company, or limited partnership), said entity shall provide to the Office Manager of CCWC, in writing, the name of a specific natural person ("Designated Representative") who will be considered the "Lot Owner" for all purposes herein.

31.2 The Designated Representative shall thereafter be considered to be the Lot Owner for all purposes under these Rules and Regulations, regardless of the name in which title to the applicable Lot or Lots is held. The required notice shall be provided to CCWC by the entity within thirty (30) days of acquiring ownership of the Lot(s). Said notice shall be given in the same manner as provided for in Article 4.1 of the Bylaws for CCWC.

32. Rental of Property

32.1 Persons renting a home/cabin on Camp Creek Lake are prohibited from using CCWC property for any reason other than access to and from the rented dwelling. A renter will not be allowed to: Swim, fish, operate any type of powered or non-powered watercraft, or operate an ORV on any of CCWC's trails or roads.

A copy of Restrictions that were placed in all original deeds Restrictions to lots at Camp Creek Water Company, signed upon purchase of original lots

THE STATE OF TEXAS, }
 County of Robertson } Knows All Men by These Presents

That CAMP CREEK WATER COMPANY, a private corporation, duly incorporated and doing business under the laws of the State of Texas, with its principal place of business in the Camp Creek Community in Robertson County, Texas, for and in consideration of the sum of THREE HUNDRED SEVENTY-FIVE (\$375.00) DOLLARS, to be paid by E A Holick, all in cash, the receipt of which is hereby acknowledged, and the further consideration of the agreement by the said Grantee to abide by the stipulations, restrictions, and conditions hereinafter set out and the promise to keep and perform all of the duties and obligations herein and hereby placed upon said Grantee, and the further consideration of the assumption on the part of the grantee of all taxes due upon the hereinafter conveyed property for the year 1949, has GRANTED, SOLD and CONVEYED, and by these presents does GRANT, SELL, and CONVEY, unto the said E A Holick, of the County of Brazos, State of Texas, all that certain real estate lying and being situated in Robertson County, Texas, and being a part of the J. M. Viesca Eleven League Grant and the Pedro Pereira Jose de Jesus and Mariano Grande Eleven League Survey, all in Robertson County, Texas, and being Lot Number 315 of the Camp Creek Water Company Subdivision of various tracts of land in said Leagues in Robertson County, Texas, according to the plat or said Subdivision of record in Volume 157, page 1, 2, 3, 4, 5, of the Deed records of Robertson County, Texas, to which plat and its record reference is here made for all purposes.

This conveyance is hereby made and accepted SUBJECT TO the following stipulations, restrictions, and conditions, which are covenants running with the land, and which shall apply to and be binding upon the Grantee herein, his heirs, devisees, executors, administrators, successors, and/or assigns, forever:

1. The Lot hereby conveyed is hereby declared to be a unit, and same may never be subdivided nor owned jointly in any way; said Lot may be owned only as a whole lot and by one individual at anyone particular time.
2. A nuisance of any kind shall not be allowed to occur or be maintained upon the Lot herein conveyed. Failure to properly dispose of garbage, trash, and litter of any kind, and the use of loud and vulgar language or any other thing constituting a disturbance shall be interpreted to be a nuisance within the meaning of this restriction.
3. The owner of this Lot shall not dispose of human excretia other than by approved pit-type toilet or septic tank with pressure, water, and field lines at least seventy-five (75) feet from service spillway water level of the Lake adjoining the above described Lot.
4. The above-described Lot shall be used only for residential purposes, and shall not at any time or in any manner be used for any commercial purpose whatever.
5. Rifles, pistols, or shotguns containing shot larger than No. 4 shot may not be discharged upon the above described Lot, as such instruments will endanger the life and property of surrounding Lot owners.

Violation of any of the above restrictive covenants, conditions, or agreements shall immediately and forthwith, without further action, revert the title to the herein conveyed Lot to the Camp Creek Water Company, its successors or assigns, at their option; however, Camp Creek Water Company, its successors or assigns, may, at their option, enter upon the Lot herein conveyed and summarily abate or remove the violation or nuisance at the expense of the then owner and such abatement, entry and/or removal shall in no wise be deemed a trespass, and Camp Creek Water Company its successors or assigns, shall in no way be liable for any damage by reason of such entry or removal.

The Camp Creek Water Company does hereby RESERVE to itself all mineral rights lying on, in, or under the herein conveyed Lot, and does hereby RESERVE the right to enter upon said Lot for the purpose of prospecting for, developing, producing, mining, of obtaining information in connection with the development or production and sale of any minerals that may lie in, on, under or adjacent to said Lot.

Camp Creek Water Company does FURTHER RESERVE to itself a general easement for power lines, water lines, light lines, or other utility lines necessary to carry on the business of selling water, power, or developing, producing, and selling minerals. It is expressly stipulated, however, that in no event shall any such lines, pipes, wells, or mines be located closer than seventy-five feet to any existing structure located upon said Lot.

Camp Creek Water Company does FURTHER RESERVE to itself an easement over the rear thirty feet, away from Camp Creek Lake, of all lots which have a rear width or ten feet or less. This easement is reserved for the benefit of lot owners who own lots, the rear width of which is too small to provide them ingress and egress without traveling upon adjoining lots, and that they may have ingress and egress from said lots, and is not retained for the general public, but is only retained for the purpose above set out.



TO HAVE AND TO HOLD the above-described premises, together with, all and singular, the rights and appurtenances thereto in any wise belonging, subject to said restrictions, conditions, and covenants, and reservations, unto said E A Holick, his heirs, and assigns, forever, and said corporation does hereby bind itself, its successors and assigns, to WARRENT AND FOREVER DEFEND all and singular, the said premises unto the said E A Holick, his heirs and assigns, against every person whomsoever lawfully claiming or to claim the same or any part thereof.

IN WITNESS WHEREOF, the said corporation has caused these presents to be executed by Coulter Hoppess, its President, and its corporate seal affixed at Bryan, Texas, this the 19th day of December, 1949. Revenue stamps 55¢ affixed and cancelled

W C Mitchell }
 Coulter Hoppess, President.

(SEAL)
 THE STATE OF TEXAS }
 COUNTY OF BRAZOS }

PERMIT HOLDERS LIST BY LOT NUMBERS

<u>Lot</u>	<u>Last Name</u>	<u>First Name</u>			
3	Salis	Patricia J.	53	Kyrish	Jeff and Amy
6	Douglass	Levi	54	Zradicka	Timothy
7	Douthitt	Allen & Shannon	55	Askew	Jim & Trudi
8	Douthitt	Allen & Shannon	56	Mize	Dale and Karen
9	Douglass	Levi	56A	O'Dell	Dan and Janet
10	Lawless, Jr.	Linda	56C	Baggerly	Joe and Luci
11	Lawless, Jr.	Linda	56D	Harris	Karen & Randall
12	Nash	Clark	57	Harris	Karen
13	Grove	Megan	58	Hall	Karen Kruse
14	Taggart	Gregory	59	Hall	Karen Kruse
15	Alexander	David & Kaysa	60	Hall	Karen Kruse
16	Hogard	Harold	61	Hall	Karen Kruse
17	Cruces	Zack & Eileen	63	Angonia	Dominic & Melissa Winn
18	Black	Todd & Teresa	64	Longenecker	Will & Dee Dee (Diane)
19	Kindle	Stanley and Barbara	65	Smith	Karen K.
20	Black	Alice	66	Fick Sr.	Donald & Linda
21	Schiller	Ruth	67	Jennings	Linda
22	Martine	Rodney	68	Meyer	Phyllis and Doug Sweeney
23	Vance	Charlene	69	Wantland	Cheri and Gary
24	Vance	Philip and Kirsten	70	Hall	Roy Wayne
25	Jepsen	Mogens and Candy	71	Smith	Don and Monie
26	Guilfoyle	Edmund and Shelley	72	Cathcart	Arthur
27	Dillon	Joy Reinhart	73	Ward	Michael and Lisa
28	Nettles	Bentley and Tracy	74	Elliot	Judy B.
29	Damon	Juanita	75	Smith	Joe E (Jody)
30	Bingham	William & Sheron	76	Wakefield	Mark & Sandy
31	Douglas	Brenda	77	Capps	Ken & Connie
32	Priestly	Robert and Emilie	78	Jones	David
33	Willingham	Dennis	79	Patton	Larry and Carol
34	Elrod	Kenneth & Ruby	80	Sheridan	Roger
35	Poole	Dan and Debbie	81	Sheridan	Jeanne & Roger
36	Whisenhunt	Gary and Marie	82	Smith	Scott & Rochelle
37	Matthews	Frank and Ann	83	Stanley	Rusty Barrett
38	Hardy	John and Toni	84	Espinoza	Shelley
39	Vincent	David and Deborah	85	Schrader	Mike and Donna
40	Vincent	David	86	Kiser - SVS HAYPARK LLC	Stacey C
41	Tears	Nelson and Marilyn	87	Shindler	George and Beverly
42	Thompson	Christy	88	Shindler	George and Beverly
43	Lintelman	Richard and Sue	89	Browning	Brian
44	Gattis	Megan	90	Williams	Terry and Sheri
45	Gattis	Megan	91	Williams	Terry G.
46	Gattis	William and Megan	92	Kipp	Adrienne
47	Fitzwater	Loftus & Lea	93	Kipp	Adrienne
48	Helmcamp	Jeff and Linda	94	Kipp	Adrienne
49	Helmcamp	Jeff and Linda	95	DeHart	Howard
50	Sawyer	Lisa and Tim	96	Cozart	Camille
51	Sawyer	Lisa and Tim	97	Bennett	Robert
52	Hughes	John and Cynthia	98	Bennett	Robert
52 R	O'Neal	Ray	99	Bennett	Derek

PERMIT HOLDERS LIST BY LOT NUMBERS

100	Byrd	Tammy & Robert	153	McKean	Wick and Janice
101	Touchstone	Steven and Lisa	154	Mederos	Amy A.
102	Perkins	Hubert and Helen	155	Thornton	Doug and Vanessa
103	Greenwood	David	156	Bayles	Ben
104	Koslosky	Ed	157	Bravenec	J. R. & Lynda
108	Howell	Barry and Tonna	157A	Acord	Ken
109	Howell	Scott	158	McReynolds	Robert and SuEarl
110	Erratt	Bruce & Tamie	159	Smith	Randal
111	Bayer	Michael & Janice	160	Smith	Randal
112	Ploeger	Eric and Jane Kee	161	Smith	Randal
113	Kee	Alex	162	Smith	Randal
114	Garrett	Reilly	164	Rudasill	Koby & Kendall
116	Tate	Michael	168	McIlwain	Jerry
117	Tate	Michael	169	Stewart	Kristopher and Stephanie
119	Menn	Wallace and Cyndy	170	Resnick	Bert and Gloria
120	Phipps	Patsy	171	Greer	Michael & Perrette Seniff
121	Keeter	April and Richard Bush	172	Crum	Ralph
122	Browning	David & Jami	173	Beard	William & Emily
123	Ingram	Robert	174	Stroud	Barry
124	Goode	Keith & Katherine	175	Hughes	Ken and Nancy
125	Giles	Scott	176	Apana	Sylvia and Lionel
126	Ellison	Charles	177	Schuenke	W.F. (Candy)
127	Russell	Aaron	178	Nelson	Barry C.
128	Cooper	Maryvonne	179	Nelson	Barry C.
129	Cooper	Maryvonne	180	Mancuso	Cullen and Patti
129A	Berry	Leonard & Nancy	181	Teeter, Jr.	Floyd & Kelly
131	Davis III	Alfred & Sue Ellen	182	Bridwell	E.W. & Bea
132	Craig	Edith (Edie)	182A	Stavinoha	Donna
133	Garrett	Lori and Doug	182B	Wax	Brandi S.
134	Cromeens	Karalynn	182C	Cave	Les
135	Cromeens	Karalynn	182D	Smith	Sam
136	Westhusin	Mark	182E	Caubarreaux	Christopher
137	Seeton	Gerald and Robbin	183	Baxter	William and Toni
138	Ruffino	Richard	184	McGuire	R. Wayne and Martica
139	Trubee	Donna	184A	Bishop	Alfred & Lisa
139	Trubee	Donna & Norman	184B	Myatt	Wade & Yolanda
140	Horlen	Joe and Becky	184B1	Cate	Patricia
141	Powell	Tim and Vivian	184B2	Williams	Mike and Paulette
142	Bowling	W. James & Janie	184C	Maulsby	Kent and Stephanie Pedigo
143	Bielamowicz	Robert & Carol	185	Pedigo	John and Mary
144	Villanueva	Roger	185A	Pedigo	John and Mary
145	Brown	Bryan & Claire	185B	Schinzler	Mark and Crystal
146	Callaway	James & JoEllen	185C	Teetes	George and Ellen Watson
147	Drever	Mary	185D	Raley	Ryan and Melissa
148	Vasquez	Bobby and Michelle	186	Stephenson	Sandel
149	Hetu	Dennis and Otilia	187	Edmondson	John & Teresa
150	Cooper	Clint and Brandi	188	Chandler	Dwight & Dawn
151	Burns	Scott & Lisa	189	Lay	Billy and Mary Jo
152	Campsey	Thomas & Carol	190	Schieffer	Dean and Tracy

PERMIT HOLDERS LIST BY LOT NUMBERS

191	Magill	Mary Jane	234	Drozd	Mark & Amy
192	Briggs	Jerry & Cynthia	236	Karstadt	Larry and Kate
193	Bouldin	Billie	237	Curtsinger	Zachary
194	Henkel	Sean & Lisa Ann	238	Hoppess	Martha
195	Robison	Kenneth and Linda	239	Cromeens	Benjamin
195A	Robison	Kenneth and Linda	240	Morgan	Richard
195B	Leissner	Helen	241	Morgan	Richard
196	Seale	Frank	242	Baen	Paul
197	Cook	Nathan & Cathy	243	Crouch	Steve & Marcia
198	Hughes	John and Cynthia	244	Hutchison	Dianna and Jack
199	Warren	Billy and Linda	245	Stone	James and Libby
200	Marsh	Jason and Brenda	246	Stone	James and Libby
201	Varvel, Jr.	Dennis & Sandra	247	Stone	James and Libby
202	Inman	Steve	248	Neff	Joe
203	Ekas	David & Marian Jamieson	249	Fiedler	James
203A	Jacobs	Steven	250	Forrester	Terry & Teresa
203B	Fazzino	Gregory and Kimberly	251	Hoppess	Karl
204	Trotter	Martha	252	Kveton	Keith and Deborah
205	Dorsett	Paul & Lynsey	253	Bickham	Bruce
206	Jones	Cody and Chelsea	254	Jett	Jim and Gina
207	Conlee	Kay	255	Jett	Jim
208	Matthews	Cody	256	Forrester	N. David & Raelene
209	Matthews	Hugh and Betty	257	Cummins	Cynthia
210	Fallwell	William & Dianne	258	Kohlleffel	Kelly and Ashley
211	Forrest	Craig	259	Kohlleffel	Kelly
212	Crane	Joe & Tricia	260	Kohlleffel	Henry & Karen
212A	Griffin	Stephen & Elizabeth	260A	Nowka	Kevin and Lisa
212B	Leftwich	Josh	261	Trageser	Ronald and Jennifer
213	Watkins	Joni	262	Fox	John T.
214	Anderson	Charles and Cathy	264	Link	Lawrence
215	Moon	Rick and Toni	265	Dobbs	Robert & Shelley
216	Cole	Dennis & JoAnn	267	McFarland	William and Bobette
217	Dixon	David	270A	Allday	Sharlene N.
218	Prock	Robert and Linda	271	Allday	Taylor
219	Martin	Koby and Crystal	272	Kohlleffel	Samuel
220	Rust	Ronald and Candy	273	Harrison	Honey
221	Davis	Thomas Webb	274	Hooker	Wallace
222	Miller	Nancy & Chris	275	Hooker	Wallace
223	Frank	Chad & Erin	276	Hooker	Calvin and Jo Gross
224	Russell	Don	277	Hooker	Calvin
225	Coyle	Patrick & Jeanne	278	Bramhall	J. P. & Belle
226	Hogan	Jerry	279	Bramhall	Bobby
227	Martin	Diane	280	Hammond	Terry
228	Smith	Delbert and Glynda	281	Crabb	Carie
229	Callaway	Thomas & Katherine	282	Courtney	Randall & Tammy
230	Gritter	Henry and Kay	283	Westerheim	Dan and Catherine
231	Reed	Jerry	284	Pierson	Larry
232	Johnson	Ronald & Diane	285	Hoyle	Carolyn
233	Stanzel	Robert	286	Dronen	Norman & Nancy

PERMIT HOLDERS LIST BY LOT NUMBERS

287	Bennett	William	335	Huckstep	Joe & Stefanie
288	Kopetsky	Alan and Holly	336	Valdez	Alfred & Lorene
289	Caubarreaux	Michael D.	337	Keane	Frank
290	Goss	Daryl and Jennifer	338	Stawnicz	Marion
291	Goss	Daryl	339	Crowell	Charles & Teresa
292	Gressett	M. Jack and Cindy	340	Higgins	Mike and Janet
293	Pate, Sr	Randall Keith	341	Higgins	Mike
294	Weisman	Jocelyn	342	Douthitt	Scott & Kris Maxymof
295	Vidrine	Scot	343	Dileo	Luke & Carla
296	Odneal	Rodney	344	Coll	Kelly & Eric
297	Matthews	E. Ray and Monalisa	345	Prowell	Fred
298	Lewis	Harold and Linda	346	Bassett	Keith & Gennette
299	Lewis	Harold and Linda	347	Wescott	Thomas
300	Malhmann	Michael and Candice	348	Houde	Raymond and Margaret
301	Malhmann	Michael and Candice	349	Walker	Sondra
302	Lunsford	James & Lisa	350	Bunda	Tim & Elisa
303	Trimble	Randy and Cathy	351	Lewis	Jerry and Fay, Gregory
303A	Reed, III	Andy and Cathy	351A	Mareth	Jean
304	Noack	Michael and Terry	351A1	Milton	Danny and Kathryn
305	Noack	Michael and Terry	351A2	Artz	Gregory 'Hunter'
306	Gidley	Ronald and Rhonda	351B	Walters	Sheri
307	Welsh	John and Sydney	351C	Wolff	Mark and Cathy
308	Hubbell	Larry and Jan	351D	Askenasy	Paul and Nubia
309	Draper	Scott & Elise	352	Walker	Gary
310	Elms	Troy & Caren	353	McGee	Larry
311	Hart	Umbert and Laura	354	Grove	Mickey and Judy
312	Ellis	Keith & Debra	355	Moseley	James and Janice
313	Sarver	John and Mary	356	Wescott	James and Lisa
314	Bell	Maurey	357	Wescott	James
315	Perry	Frank and Anne	358	Martin	Shonda
316	Roper	Kerwin and Debbie	359	Allen	Mike and Sandra
317	Brault	Roger & Lynnette	360	Greig	John and Linda
318	Holditch	Ann	361	Greig	Michael
319	French	Edward & Patricia	362	Kirk	Rodney and Jeanne
320	Mackey	Thomas and Holly Chandler	363	Powell	Ray and Phyllis
321	Mackey	Thomas and Holly Chandler	364	Kahil	Mark and Cindy
322	Norris	Trent & Dayna Owen	365	Sousares	Michael
323	Hooks	Howard & Melissa	366	Strzelec	Wally and Freda
324	Newman IV	Louis M & Emily Smith	367	Mareth	Mac
325	Gunderson	Linda	368	Lyon III	Stephen and Rochelle
326	Veazey	Barry and Patty	369	Lyon, III	Stephen and Rochelle
327	Astle	Larry & Patsy	370	Lyon, IV	Stephen Mark and Annie
328	Loy	Susan and Christopher	371	Hlavinka	Sarah Elizabeth
329	Hicks	David	372	Hobbs	Gary and Amy
330	Kline	Joe and Kristin	372A	Mertz	Paul and Elizabeth
331	McComb	Clarence and Patricia	373	Cromeens	Barton
332	Singleton	Howard	374	Hicks	Dorothy
333	Cooper	Prentice & Kim	375	LaFonte	Brian & Lauren Miller
334	Seymour	Jason	376	Singleton	Howard

PERMIT HOLDERS LIST BY LOT NUMBERS

377	Mallard	Kenny and Ann	433	Jackson	Davis
378	Montz	David and Kimberly	434	Lawrence	Sandy
379	Schaefer	Michael and Sandra	435	Largent	Mary
380	Taylor	Russell and Alice	436	Singleton	Howard
381	Goehring	Dennis and Kay	445	Beauchamp	Mark Reed
382	Abello	Carlos and April	446	Didsbury	Crayden & Linda
383	Fisler	Catherine	447	Jackson	Jerry and Donna
384	Goehring-Jones	Laura and Jim	448	Weisser	Mark
385	Goehring-Dickerson	Tracey and Charlie	449	Weisser	Mark
386	Alspaugh	Rob & Anita	450	Garrett	Phillip and Donna
388	Adams	Mary	451	Garrett	Phillip
389	Terry	Judith	452	Molina	Ricardo
390	Gordon	Brett & Dana	453	Hazlewood	Jeff
391	Dezell	Shannon	454	Parsons	Larry
392	Presnal	Henry			
393	Haji	Karim			
394	Smeins	Fred and Judith			
395	Stauffer	Curtis and Cheryl			
396	Cahill	Kim & Lynn D.			
397	Batten	Pat			
398	Kocman	Frances H.			
399	Wiley	Cade and Randi			
400	Kocman	Mike			
401	Martin	Mike and Anna			
402	Martin	Mike			
403	Blackburn	Brian & Emily			
403A	Brasher	James			
404	DeSalvo	Diane			
405	Stennis	Beverly			
406	Fleming	Jennifer & Darrell Daniel			
407	Siantar Investments I, LP	Oscar Parulian			
408	Wisakowsky	Keith E			
409	Wisakowsky	Eugene and Lynn			
417	Weisser	Sonya			
418	Cooper	Gary & Lisa			
419	Lunsford	Jack and Janice			
420	Williamson	Keith and Kim			
421	Ruffino	J.J. and Cherry			
422	Kissinger	Kip			
423	Peirce	Charles K.			
424	Pate	Randall and Keely			
425	German	John and LaNell			
426	Kitterman	Robert & Judy			
427	Luckie	Tami and Kelly Smith			
428	Luckie	Tami			
429	Luckie	Tami			
430	Sides	Larry and Tina			
431	Goolsby	Charles and Karen			
432	Griffiths	Dawn			

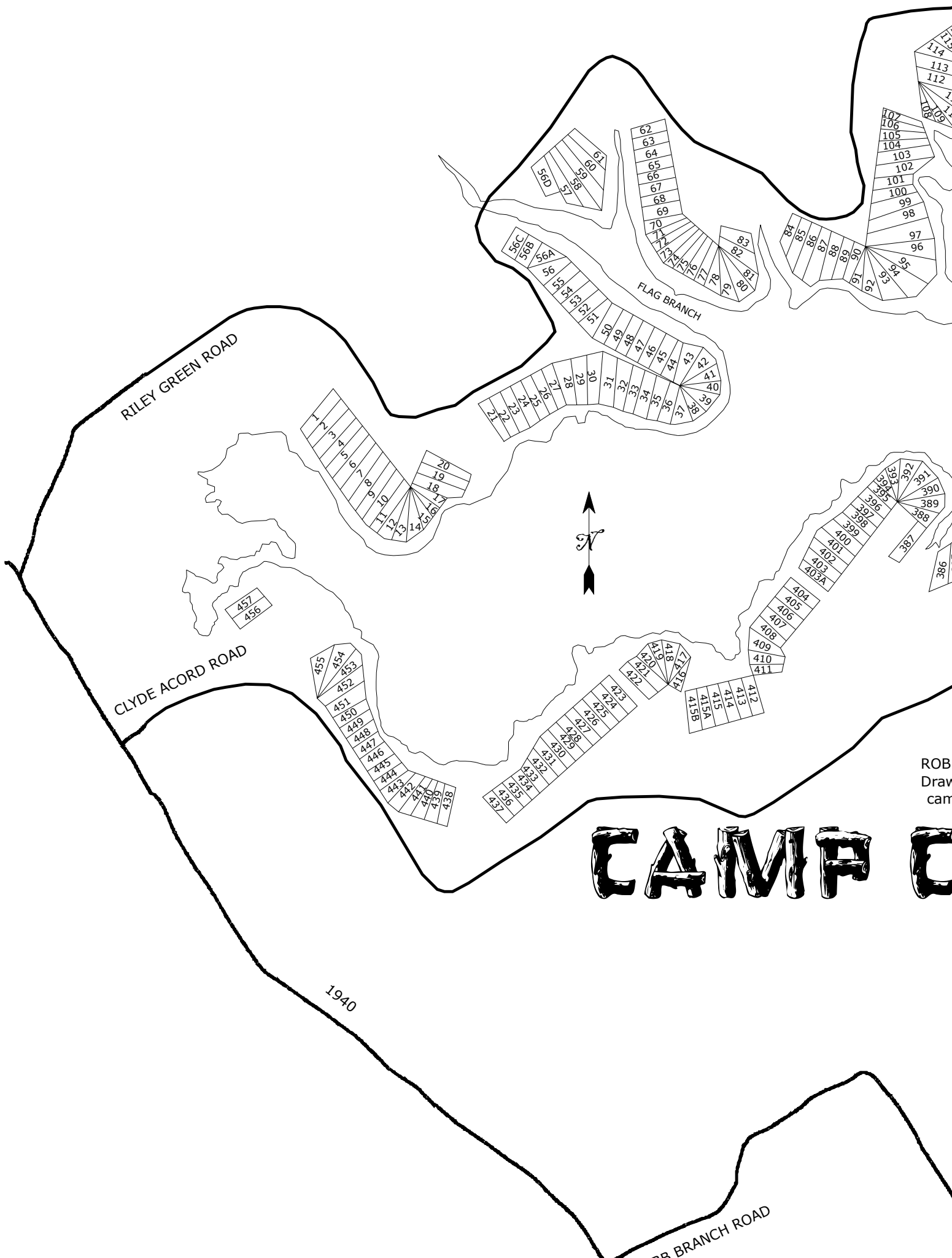

RILEY GREEN ROAD

CLYDE ACORD ROAD

FLAG BRANCH

CAMP D

1940

FLAG BRANCH ROAD

ROB
Draw
cam

Camp Creek Office



HERTSON COUNTY, TEXAS
 Town By: John R. Hoyle Jr.
 campcreekmap@gmail.com
 2022 Edition

CAMP CREEK LAKE

Clyde Acord Road

Cobb Branch Road

C. Hoppess Road

RECREATION AREA AND BOAT RAMP

BOAT RAMP

SKI AREA

DAM

BUTLER COVE

BEE BRANCH

COBB BRANCH

CARSON'S COVE

ALLIGATOR COVE

PERMIT HOLDERS LIST ALPHABETICALLY

<u>Lot</u>	<u>Last Name</u>	<u>First Name</u>			
382	Abello	Carlos and April	350	Bunda	Tim & Elisa
157A	Acord	Ken	151	Burns	Scott & Lisa
388	Adams	Mary	100	Byrd	Tammy & Robert
15	Alexander	David & Kaysa	396	Cahill	Kim & Lynn D.
271	Allday	Taylor	146	Callaway	James & JoEllen
270A	Allday	Sharlene N.	229	Callaway	Thomas & Katherine
359	Allen	Mike and Sandra	152	Campsey	Thomas & Carol
386	Alspaugh	Rob & Anita	77	Capps	Ken & Connie
214	Anderson	Charles and Cathy	184B1	Cate	Patricia
63	Angonia	Dominic & Melissa Winn	72	Cathcart	Arthur
176	Apana	Sylvia and Lionel	289	Caubarreaux	Michael D.
351A2	Artz	Gregory 'Hunter'	182E	Caubarreaux	Christopher
351D	Askenasy	Paul and Nubia	182C	Cave	Les
55	Askew	Jim & Trudi	188	Chandler	Dwight & Dawn
327	Astle	Larry & Patsy	216	Cole	Dennis & JoAnn
242	Baen	Paul	344	Coll	Kelly & Eric
56C	Baggerly	Joe and Luci	207	Conlee	Kay
346	Bassett	Keith & Gennette	197	Cook	Nathan & Cathy
397	Batten	Pat	128	Cooper	Maryvonne
183	Baxter	William and Toni	129	Cooper	Maryvonne
111	Bayer	Michael & Janice	150	Cooper	Clint and Brandi
156	Bayles	Ben	333	Cooper	Prentice & Kim
173	Beard	William & Emily	418	Cooper	Gary & Lisa
445	Beauchamp	Mark Reed	282	Courtney	Randall & Tammy
314	Bell	Maurey	225	Coyle	Patrick & Jeanne
97	Bennett	Robert	96	Cozart	Camille
98	Bennett	Robert	281	Crabb	Carie
99	Bennett	Derek	132	Craig	Edith (Edie)
287	Bennett	William	212	Crane	Joe & Tricia
129A	Berry	Leonard & Nancy	134	Cromeens	Karalynn
253	Bickham	Bruce	135	Cromeens	Karalynn
143	Bielamowicz	Robert & Carol	239	Cromeens	Benjamin
30	Bingham	William & Sheron	373	Cromeens	Barton
184A	Bishop	Alfred & Lisa	243	Crouch	Steve & Marcia
18	Black	Todd & Teresa	339	Crowell	Charles & Teresa
20	Black	Alice	17	Crues	Zack & Eileen
403	Blackburn	Brian & Emily	172	Crum	Ralph
193	Bouldin	Billie	257	Cummins	Cynthia
142	Bowling	W. James & Janie	237	Curtsinger	Zachary
278	Bramhall	J. P. & Belle	29	Damon	Juanita
279	Bramhall	Bobby	221	Davis	Thomas Webb
403A	Brasher	James	131	Davis III	Alfred & Sue Ellen
317	Brault	Roger & Lynnette	95	DeHart	Howard
157	Bravenec	J. R. & Lynda	404	DeSalvo	Diane
182	Bridwell	E.W. & Bea	391	Dezell	Shannon
192	Briggs	Jerry & Cynthia	446	Didsbury	Crayden & Linda
145	Brown	Bryan & Claire	343	Dileo	Luke & Carla
89	Browning	Brian	27	Dillon	Joy Reinhart
122	Browning	David & Jami	217	Dixon	David

PERMIT HOLDERS LIST ALPHABETICALLY

265	Dobbs	Robert & Shelley	390	Gordon	Brett & Dana
205	Dorsett	Paul & Lynsey	290	Goss	Daryl and Jennifer
31	Douglas	Brenda	291	Goss	Daryl
6	Douglass	Levi	103	Greenwood	David
9	Douglass	Levi	171	Greer	Michael & Perrette Seniff
7	Douthitt	Allen & Shannon	360	Greig	John and Linda
8	Douthitt	Allen & Shannon	361	Greig	Michael
342	Douthitt	Scott & Kris Maxymof	292	Gressett	M. Jack and Cindy
309	Draper	Scott & Elise	212A	Griffin	Stephen & Elizabeth
147	Drever	Mary	432	Griffiths	Dawn
286	Dronen	Norman & Nancy	230	Gritter	Henry and Kay
234	Drozd	Mark & Amy	13	Grove	Megan
187	Edmondson	John & Teresa	354	Grove	Mickey and Judy
203	Ekas	David & Marian Jamieson	26	Guilfoyle	Edmund and Shelley
74	Elliot	Judy B.	325	Gunderson	Linda
312	Ellis	Keith & Debra	393	Haji	Karim
126	Ellison	Charles	58	Hall	Karen Kruse
310	Elms	Troy & Caren	59	Hall	Karen Kruse
34	Elrod	Kenneth & Ruby	60	Hall	Karen Kruse
110	Erratt	Bruce & Tamie	61	Hall	Karen Kruse
84	Espinoza	Shelley	70	Hall	Roy Wayne
210	Fallwell	William & Dianne	280	Hammond	Terry
203B	Fazzino	Gregory and Kimberly	38	Hardy	John and Toni
66	Fick Sr.	Donald & Linda	56D	Harris	Karen & Randall
249	Fiedler	James	57	Harris	Karen
383	Fisler	Catherine	273	Harrison	Honey
47	Fitzwater	Loftus & Lea	311	Hart	Umbert and Laura
406	Fleming	Jennifer & Darrell Daniel	453	Hazlewood	Jeff
211	Forrest	Craig	48	Helmcamp	Jeff and Linda
250	Forrester	Terry & Teresa	49	Helmcamp	Jeff and Linda
256	Forrester	N. David & Raelene	194	Henkel	Sean & Lisa Ann
262	Fox	John T.	149	Hetu	Dennis and Otilia
223	Frank	Chad & Erin	329	Hicks	David
319	French	Edward & Patricia	374	Hicks	Dorothy
114	Garrett	Reilly	340	Higgins	Mike and Janet
133	Garrett	Lori and Doug	341	Higgins	Mike
450	Garrett	Phillip and Donna	371	Hlavinka	Sarah Elizabeth
451	Garrett	Phillip	372	Hobbs	Gary and Amy
44	Gattis	Megan	226	Hogan	Jerry
45	Gattis	Megan	16	Hogard	Harold
46	Gattis	William and Megan	318	Holditch	Ann
425	German	John and LaNell	274	Hooker	Wallace
306	Gidley	Ronald and Rhonda	275	Hooker	Wallace
125	Giles	Scott	276	Hooker	Calvin and Jo Gross
381	Goehring	Dennis and Kay	277	Hooker	Calvin
385	Goehring-Dickerson	Tracey and Charlie	323	Hooks	Howard & Melissa
384	Goehring-Jones	Laura and Jim	238	Hoppess	Martha
124	Goode	Keith & Katherine	251	Hoppess	Karl
431	Goolsby	Charles and Karen	140	Horlen	Joe and Becky

PERMIT HOLDERS LIST ALPHABETICALLY

348	Houde	Raymond and Margaret	11	Lawless, Jr.	Linda
108	Howell	Barry and Tonna	434	Lawrence	Sandy
109	Howell	Scott	189	Lay	Billy and Mary Jo
285	Hoyle	Carolyn	212B	Leftwich	Josh
308	Hubbell	Larry and Jan	195B	Leissner	Helen
335	Huckstep	Joe & Stefanie	298	Lewis	Harold and Linda
52	Hughes	John and Cynthia	299	Lewis	Harold and Linda
175	Hughes	Ken and Nancy	351	Lewis	Jerry and Fay, Gregory
198	Hughes	John and Cynthia	264	Link	Lawrence
244	Hutchison	Dianna and Jack	43	Lintelman	Richard and Sue
123	Ingram	Robert	64	Longenecker	Will & Dee Dee (Diane)
202	Inman	Steve	328	Loy	Susan and Christopher
433	Jackson	Davis	427	Luckie	Tami and Kelly Smith
447	Jackson	Jerry and Donna	428	Luckie	Tami
203A	Jacobs	Steven	429	Luckie	Tami
67	Jennings	Linda	302	Lunsford	James & Lisa
25	Jepsen	Mogens and Candy	419	Lunsford	Jack and Janice
254	Jett	Jim and Gina	368	Lyon III	Stephen and Rochelle
255	Jett	Jim	369	Lyon, III	Stephen and Rochelle
232	Johnson	Ronald & Diane	370	Lyon, IV	Stephen Mark and Annie
78	Jones	David	320	Mackey	Thomas and Holly Chandler
206	Jones	Cody and Chelsea	321	Mackey	Thomas and Holly Chandler
364	Kahil	Mark and Cindy	191	Magill	Mary Jane
236	Karstadt	Larry and Kate	300	Malhlmann	Michael and Candice
337	Keane	Frank	301	Malhlmann	Michael and Candice
113	Kee	Alex	377	Mallard	Kenny and Ann
121	Keeter	April and Richard Bush	180	Mancuso	Cullen and Patti
19	Kindle	Stanley and Barbara	367	Mareth	Mac
92	Kipp	Adrienne	351A	Mareth	Jean
93	Kipp	Adrienne	200	Marsh	Jason and Brenda
94	Kipp	Adrienne	219	Martin	Koby and Crystal
362	Kirk	Rodney and Jeanne	227	Martin	Diane
86	Kiser - SVS HAYPARK LLC	Stacey C	358	Martin	Shonda
422	Kissinger	Kip	401	Martin	Mike and Anna
426	Kitterman	Robert & Judy	402	Martin	Mike
330	Kline	Joe and Kristin	22	Martine	Rodney
398	Kocman	Frances H.	37	Matthews	Frank and Ann
400	Kocman	Mike	208	Matthews	Cody
258	Kohlleffel	Kelly and Ashley	209	Matthews	Hugh and Betty
259	Kohlleffel	Kelly	297	Matthews	E. Ray and Monalisa
260	Kohlleffel	Henry & Karen	184C	Maulsby	Kent and Stephanie Pedigo
272	Kohlleffel	Samuel	331	McComb	Clarence and Patricia
288	Kopetsky	Alan and Holly	267	McFarland	William and Bobette
104	Koslosky	Ed	353	McGee	Larry
252	Kveton	Keith and Deborah	184	McGuire	R. Wayne and Martica
53	Kyrish	Jeff and Amy	168	McIlwain	Jerry
375	LaFonte	Brian & Lauren Miller	153	McKean	Wick and Janice
435	Largent	Mary	158	McReynolds	Robert and SuEarl
10	Lawless, Jr.	Linda	154	Mederos	Amy A.

PERMIT HOLDERS LIST ALPHABETICALLY

119	Menn	Wallace and Cyndy	195	Robison	Kenneth and Linda
372A	Mertz	Paul and Elizabeth	195A	Robison	Kenneth and Linda
68	Meyer	Phyllis and Doug Sweeney	316	Roper	Kerwin and Debbie
222	Miller	Nancy & Chris	164	Rudasill	Koby & Kendall
351A1	Milton	Danny and Kathryn	138	Ruffino	Richard
56	Mize	Dale and Karen	421	Ruffino	J.J. and Cherry
452	Molina	Ricardo	127	Russell	Aaron
378	Montz	David and Kimberly	224	Russell	Don
215	Moon	Rick and Toni	220	Rust	Ronald and Candy
240	Morgan	Richard	3	Salis	Patricia J.
241	Morgan	Richard	313	Sarver	John and Mary
355	Moseley	James and Janice	50	Sawyer	Lisa and Tim
184B	Myatt	Wade & Yolanda	51	Sawyer	Lisa and Tim
12	Nash	Clark	379	Schaefer	Michael and Sandra
248	Neff	Joe	190	Schieffer	Dean and Tracy
178	Nelson	Barry C.	21	Schiller	Ruth
179	Nelson	Barry C.	185B	Schinzler	Mark and Crystal
28	Nettles	Bentley and Tracy	85	Schrader	Mike and Donna
324	Newman IV	Louis M & Emily Smith	177	Schuenke	W.F. (Candy)
304	Noack	Michael and Terry	196	Seale	Frank
305	Noack	Michael and Terry	137	Seeton	Gerald and Robbin
322	Norris	Trent & Dayna Owen	334	Seymour	Jason
260A	Nowka	Kevin and Lisa	80	Sheridan	Roger
56A	O'Dell	Dan and Janet	81	Sheridan	Jeanne & Roger
296	Odneal	Rodney	87	Shindler	George and Beverly
52 R	O'Neal	Ray	88	Shindler	George and Beverly
454	Parsons	Larry	407	Siantar Investments I, LP	Oscar Parulian
424	Pate	Randall and Keely	430	Sides	Larry and Tina
293	Pate, Sr	Randall Keith	332	Singleton	Howard
79	Patton	Larry and Carol	376	Singleton	Howard
185	Pedigo	John and Mary	436	Singleton	Howard
185A	Pedigo	John and Mary	394	Smeins	Fred and Judith
423	Peirce	Charles K.	65	Smith	Karen K.
102	Perkins	Hubert and Helen	71	Smith	Don and Monie
315	Perry	Frank and Anne	75	Smith	Joe E (Jody)
120	Phipps	Patsy	82	Smith	Scott & Rochelle
284	Pierson	Larry	159	Smith	Randal
112	Ploeger	Eric and Jane Kee	160	Smith	Randal
35	Poole	Dan and Debbie	161	Smith	Randal
141	Powell	Tim and Vivian	162	Smith	Randal
363	Powell	Ray and Phyllis	228	Smith	Delbert and Glynda
392	Presnal	Henry	182D	Smith	Sam
32	Priestly	Robert and Emilie	365	Sousares	Michael
218	Prock	Robert and Linda	83	Stanley	Rusty Barrett
345	Prowell	Fred	233	Stanzel	Robert
185D	Raley	Ryan and Melissa	395	Stauffer	Curtis and Cheryl
231	Reed	Jerry	182A	Stavinoha	Donna
303A	Reed, III	Andy and Cathy	338	Stawnicz	Marion
170	Resnick	Bert and Gloria	405	Stennis	Beverly

PERMIT HOLDERS LIST ALPHABETICALLY

186	Stephenson	Sandel	357	Wescott	James
169	Stewart	Kristopher and Stephanie	283	Westerheim	Dan and Catherine
245	Stone	James and Libby	136	Westhusin	Mark
246	Stone	James and Libby	36	Whisenhunt	Gary and Marie
247	Stone	James and Libby	399	Wiley	Cade and Randi
174	Stroud	Barry	90	Williams	Terry and Sheri
366	Strzelec	Wally and Freda	91	Williams	Terry G.
14	Taggart	Gregory	184B2	Williams	Mike and Paulette
116	Tate	Michael	420	Williamson	Keith and Kim
117	Tate	Michael	33	Willingham	Dennis
380	Taylor	Russell and Alice	408	Wisakowsky	Keith E
41	Tears	Nelson and Marilyn	409	Wisakowsky	Eugene and Lynn
181	Teeter, Jr.	Floyd & Kelly	351C	Wolff	Mark and Cathy
185C	Teetes	George and Ellen Watson	54	Zradicka	Timothy
389	Terry	Judith			
42	Thompson	Christy			
155	Thornton	Doug and Vanessa			
101	Touchstone	Steven and Lisa			
261	Trageser	Ronald and Jennifer			
303	Trimble	Randy and Cathy			
204	Trotter	Martha			
139	Trubee	Donna			
139	Trubee	Donna & Norman			
336	Valdez	Alfred & Lorene			
23	Vance	Charlene			
24	Vance	Philip and Kirsten			
201	Varvel, Jr.	Dennis & Sandra			
148	Vasquez	Bobby and Michelle			
326	Veazey	Barry and Patty			
295	Vidrine	Scot			
144	Villanueva	Roger			
39	Vincent	David and Deborah			
40	Vincent	David			
76	Wakefield	Mark & Sandy			
349	Walker	Sondra			
352	Walker	Gary			
351B	Walters	Sheri			
69	Wantland	Cheri and Gary			
73	Ward	Michael and Lisa			
199	Warren	Billy and Linda			
213	Watkins	Joni			
182B	Wax	Brandi S.			
294	Weisman	Jocelyn			
417	Weisser	Sonya			
448	Weisser	Mark			
449	Weisser	Mark			
307	Welsh	John and Sydney			
347	Wescott	Thomas			
356	Wescott	James and Lisa			

